

Passenger - Limited Use/ Limited Access

RAIL BRACKET SUPPORTS LOCATED 1'-0" BELOW FLOOR LEVELS TYP.

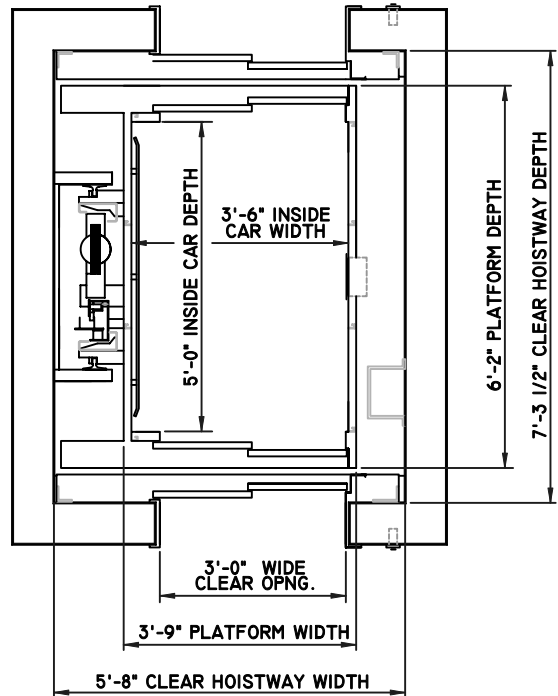

Passenger - Dual Piston Holeless

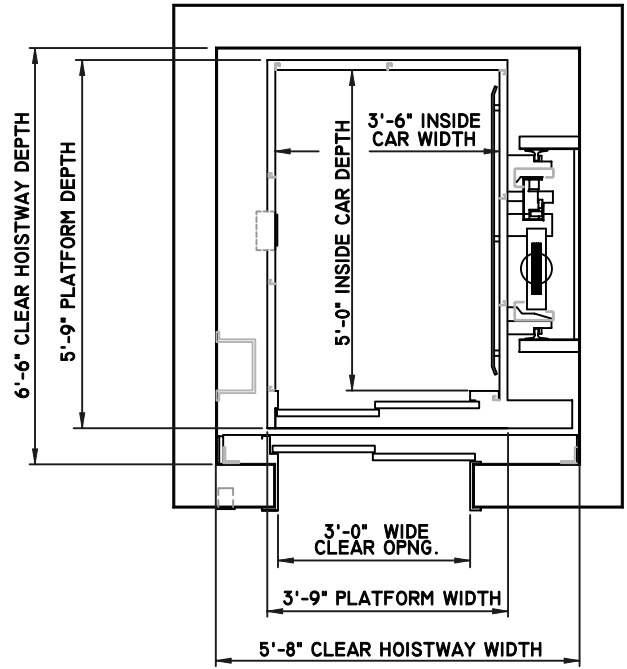
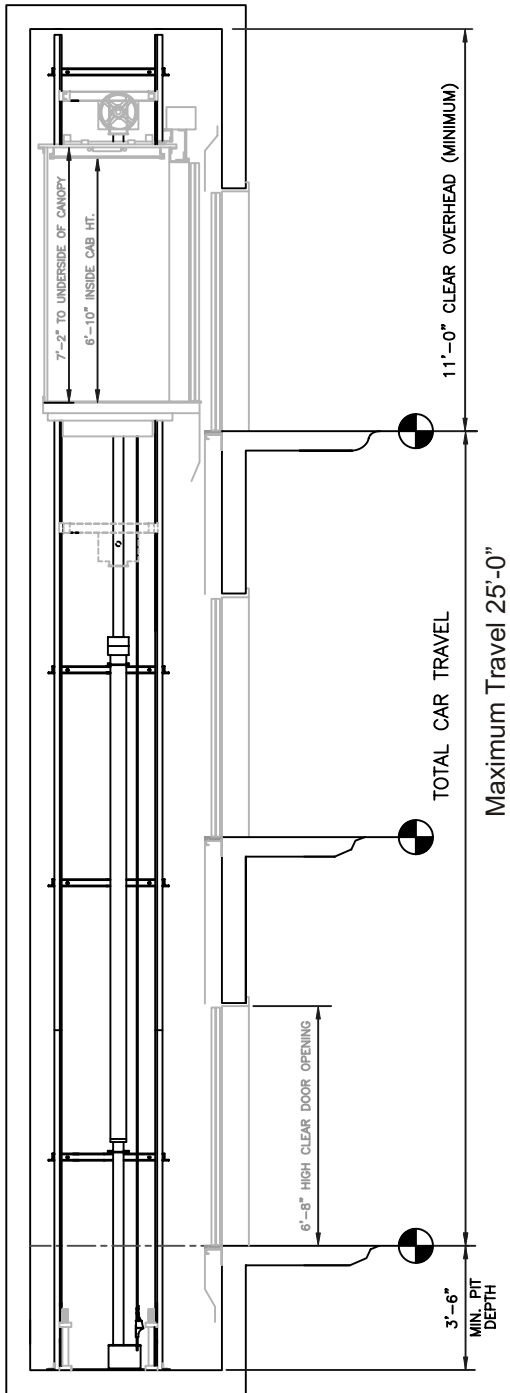
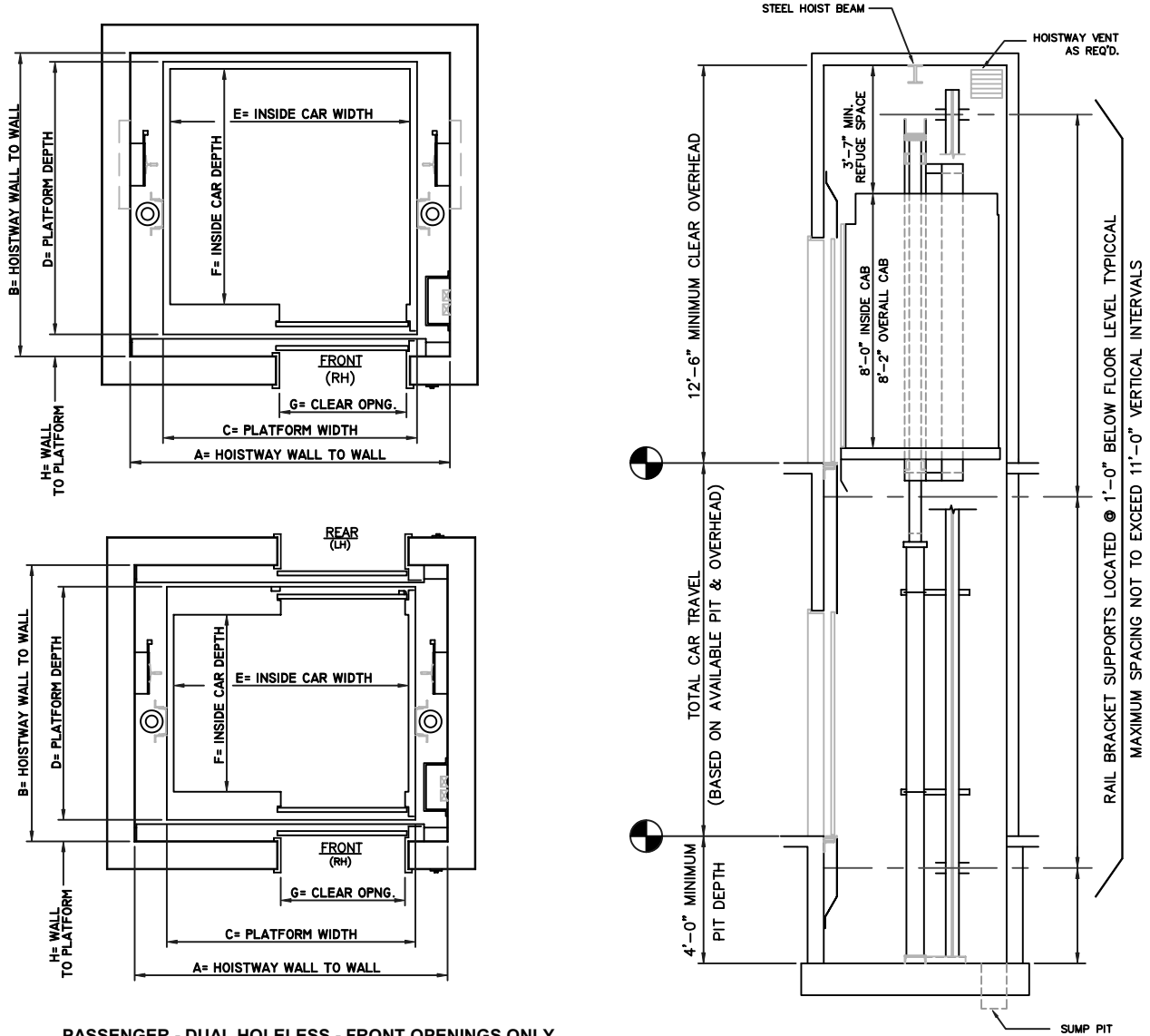

PASSENGER - DUAL HOLELESS - FRONT OPENINGS ONLY

CAPACITY	HOISTWAY		PLATFORM		CLEAR INSIDE CAR		DOOR		
	WIDTH	DEPTH	WIDTH	DEPTH	WIDTH	DEPTH	WIDTH	TYPE	MAX TRAVEL
2000	7'-6"	5'-10"	6'-0"	5'-1"	5'-8"	4'-3"	3'-0"	SSSO	26'
2500	8'-6"	5'-10"	7'-0"	5'-1"	6'-8"	4'-3"	3'-6"	SSSO	26'
3000	8'-6"	6'-3"	7'-0"	5'-6"	6'-8"	4'-8"	3'-6"	SSSO	26'
3500	8'-6"	6'-11"	7'-0"	6'-2"	6'-8"	5'-4"	3'-6"	SSSO	26'
4000	7'-6"	9'-6 1/2"	6'-0"	8'-8"	5'-8"	7'-8"	4'-0"	2SSO	26'
4500	7'-6"	9'-10 1/2"	6'-0"	9'-0"	5'-8"	8'-0"	4'-0"	2SSO	26'

PASSENGER - DUAL HOLELESS - FRONT AND REAR OPENINGS

CAPACITY	HOISTWAY		PLATFORM		CLEAR INSIDE CAR		DOOR		
	WIDTH	DEPTH	WIDTH	DEPTH	WIDTH	DEPTH	WIDTH	TYPE	MAX TRAVEL
2000	7'-6"	6'-7 1/2"	6'-0"	5'-7"	5'-8"	4'-3"	3'-0"	SSSO	26'
2500	8'-6"	6'-7 1/2"	7'-0"	5'-7"	6'-8"	4'-3"	3'-6"	SSSO	26'
3000	8'-6"	7'-3 1/2"	7'-0"	6'-3"	6'-8"	4'-11"	3'-6"	SSSO	26'
3500	8'-6"	7'-8 1/2"	7'-0"	6'-8"	6'-8"	5'-4"	3'-6"	SSSO	26'
4000	7'-6"	10'-7 1/2"	6'-0"	9'-4"	5'-8"	7'-8"	4'-0"	2SSO	26'
4500	7'-6"	10'-11 1/2"	6'-0"	9'-8"	5'-8"	8'-0"	4'-0"	2SSO	26'

Passenger - Dual Roped Holeless

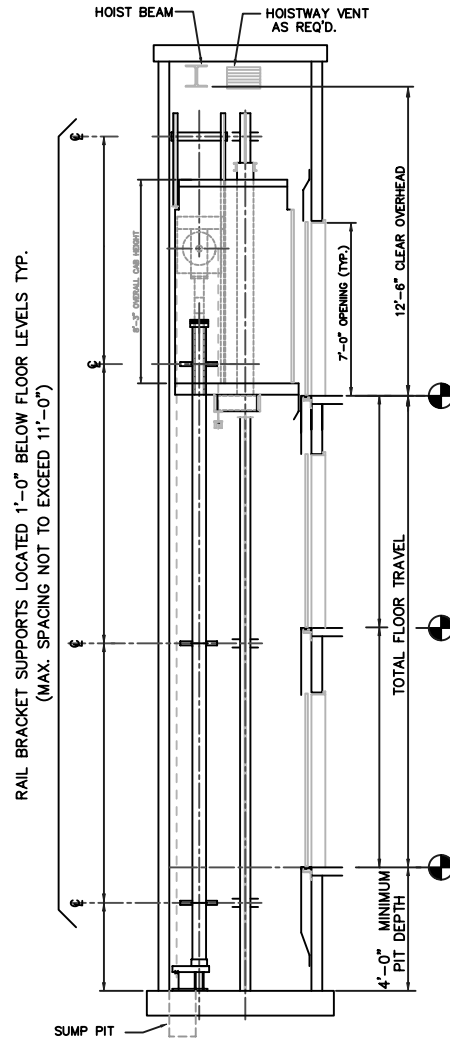
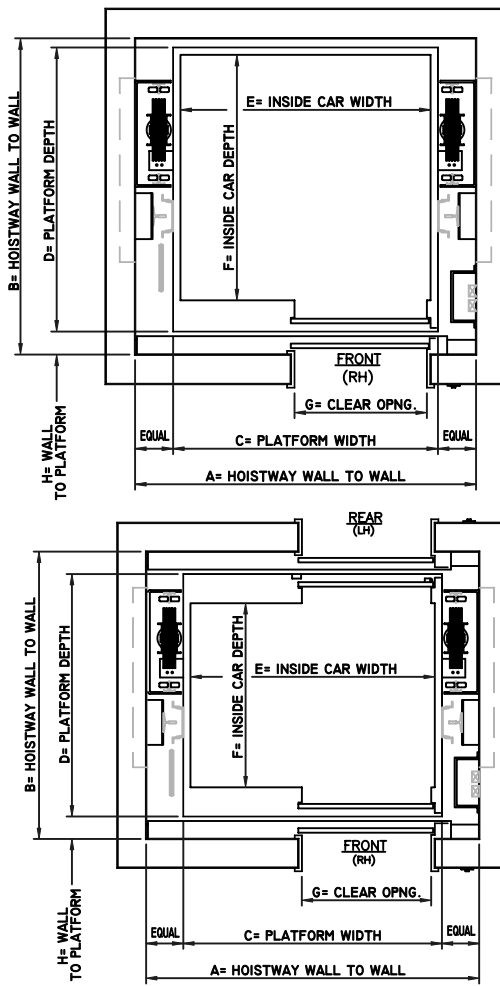

PASSENGER - ROPED HOLELESS - FRONT OPENINGS ONLY

CAPACITY	HOISTWAY		PLATFORM		CLEAR INSIDE CAR		DOOR		
	WIDTH	DEPTH	WIDTH	DEPTH	WIDTH	DEPTH	WIDTH	TYPE	MAX TRAVEL
2000	7'-6"	5'-10"	6'-0"	5'-1"	5'-8"	4'-3"	3'-0"	SSSO	40'
2000	7'-7"	5'-10"	6'-0"	5'-1"	5'-8"	4'-3"	3'-0"	SSSO	70'
2500	8'-7"	5'-10"	7'-0"	5'-1"	6'-8"	4'-3"	3'-6"	SSSO	65'
2500	8'-10"	5'-10"	7'-0"	5'-1"	6'-8"	4'-3"	3'-6"	SSSO	90'
3000	8'-7"	6'-3"	7'-0"	5'-6"	6'-8"	4'-8"	3'-6"	SSSO	65'
3000	8'-10"	6'-3"	7'-0"	5'-6"	6'-8"	4'-8"	3'-6"	SSSO	90'
3500	8'-8"	6'-11"	7'-0"	6'-2"	6'-8"	5'-4"	3'-6"	2SSO	55'
3500	8'-11"	6'-11"	7'-0"	6'-2"	6'-8"	5'-4"	3'-6"	2SSO	70'
4000	7'-11"	9'-6 1/2"	6'-0"	8'-8"	5'-8"	7'-8"	4'-0"	2SSO	55'
4500	7'-11"	9'-10 1/2"	6'-0"	9'-0"	5'-8"	8'-0"	4'-0"	2SSO	80'

PASSENGER - ROPED HOLELESS - FRONT AND REAR OPENINGS

CAPACITY	HOISTWAY		PLATFORM		CLEAR INSIDE CAR		DOOR		
	WIDTH	DEPTH	WIDTH	DEPTH	WIDTH	DEPTH	WIDTH	TYPE	MAX TRAVEL
2000	7'-6"	6'-7 1/2"	6'-0"	5'-7"	5'-8"	4'-3"	3'-0"	SSSO	25'
2000	7'-7"	6'-7 1/2"	6'-0"	5'-7"	5'-8"	4'-3"	3'-0"	SSSO	70'
2500	8'-7"	6'-7 1/2"	7'-0"	5'-7"	6'-8"	4'-3"	3'-6"	SSSO	65'
2500	8'-10"	6'-7 1/2"	7'-0"	5'-7"	6'-8"	4'-3"	3'-6"	SSSO	90'
3000	8'-7"	7'-3 1/2"	7'-0"	6'-3"	6'-8"	4'-11"	3'-6"	SSSO	60'
3000	8'-10"	7'-3 1/2"	7'-0"	6'-3"	6'-8"	4'-11"	3'-6"	SSSO	85'
3500	8'-8"	7'-8 1/2"	7'-0"	6'-8"	6'-8"	5'-4"	3'-6"	2SSO	45'
3500	8'-11"	7'-8 1/2"	7'-0"	6'-8"	6'-8"	5'-4"	3'-6"	2SSO	85'
4000	7'-11"	10'-7 1/2"	6'-0"	9'-4"	5'-8"	7'-8"	4'-0"	2SSO	80'
4500	7'-11"	10'-11 1/2"	6'-0"	9'-8"	5'-8"	8'-0"	4'-0"	2SSO	75'

Passenger - Cantilevered Roped Holeless

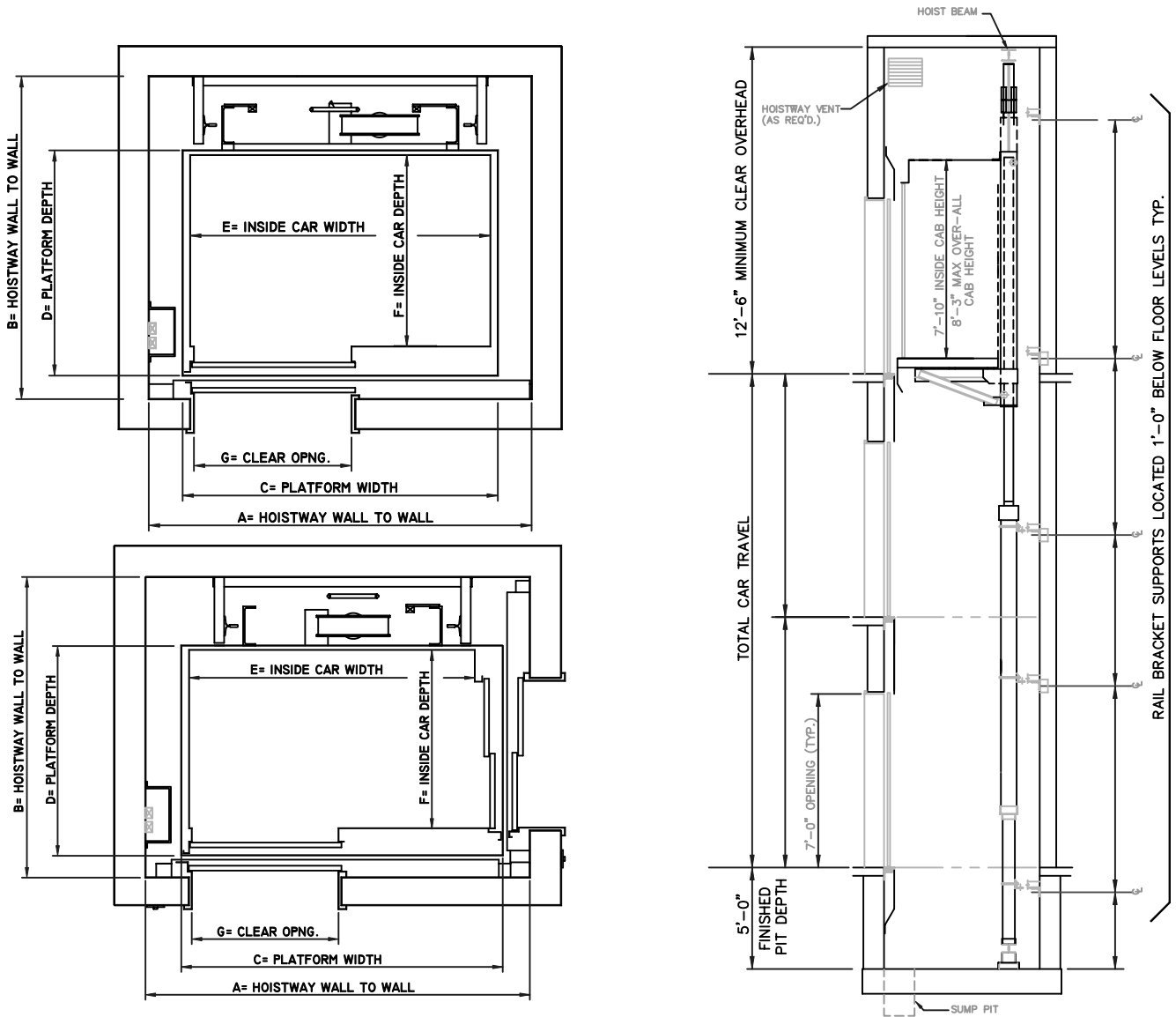

PASSENGER - ROPED HOLELESS CANTILEVER - FRONT OPENINGS

	HOISTWAY		PLATFORM		CLEAR INSIDE CAR		DOOR		
	WIDTH	DEPTH	WIDTH	DEPTH	WIDTH	DEPTH	WIDTH	TYPE	MAX TRAVEL
CAPACITY	A	B	C	D	E	F	G		
2000	7'-4"	7'-0"	6'-0"	5'-1"	5'-8"	4'-3"	3'-0"	SSSO	90'
2500	8'-4"	7'-0"	7'-0"	5'-1"	6'-8"	4'-3"	3'-6"	SSSO	90'

PASSENGER - ROPED HOLELESS CANTILEVER - FRONT AND SIDE OPENINGS

	HOISTWAY		PLATFORM		CLEAR INSIDE CAR		DOOR		
	WIDTH	DEPTH	WIDTH	DEPTH	WIDTH	DEPTH	WIDTH	TYPE	MAX TRAVEL
CAPACITY	A	B	C	D	E	F	G		
2000	8'-0"	7'-0"	6'-8"	5'-1"	5'-8"	4'-3"	3'-0"	2SSO	90'
2500	9'-0"	7'-0"	7'-8"	5'-1"	6'-8"	4'-3"	3'-6"	2SSO	90'

Passenger - Basement Traction

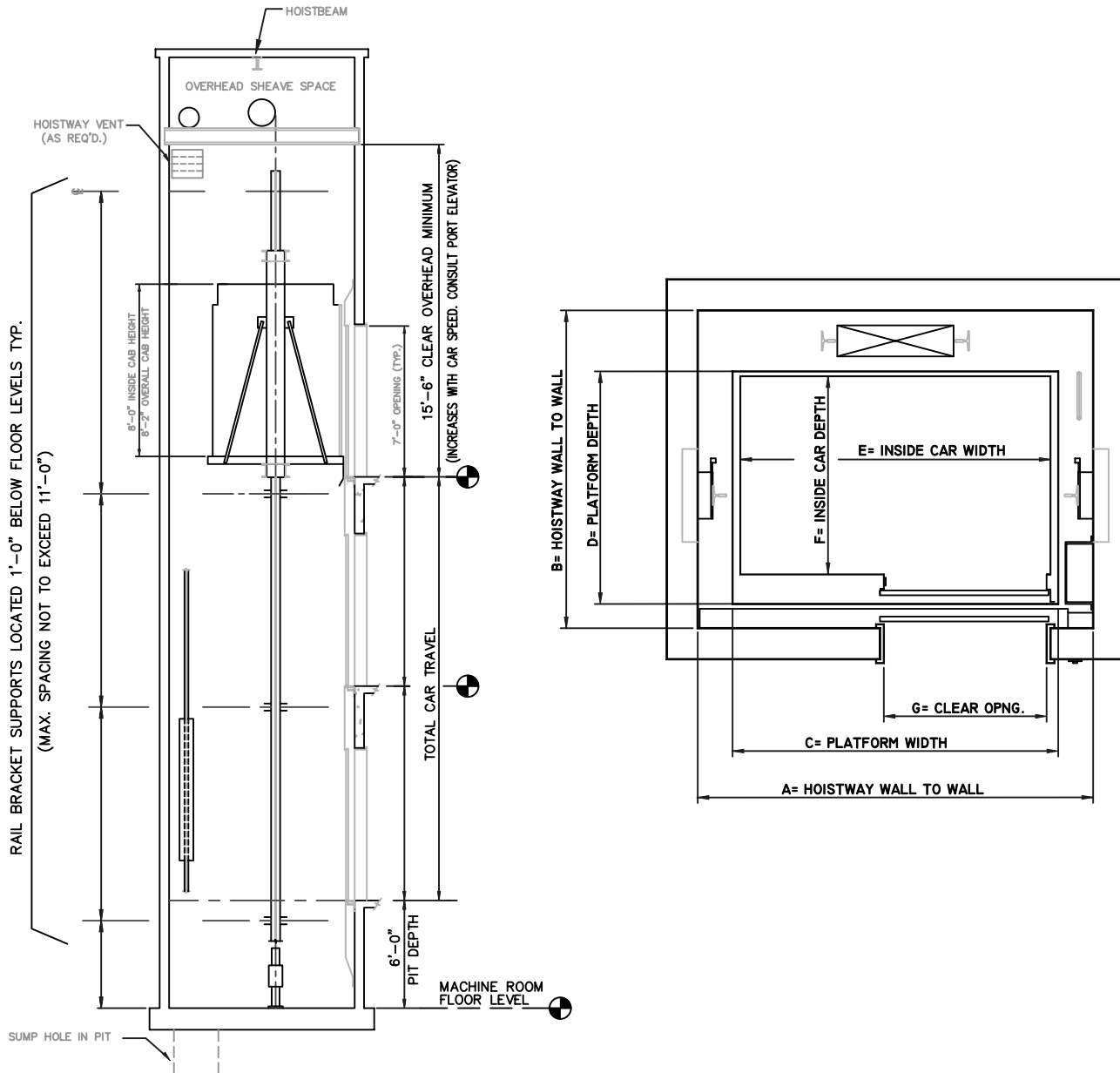

PASSENGER - BASEMENT TRACTION - FRONT OPENINGS ONLY

	HOISTWAY		PLATFORM		CLEAR INSIDE CAR		DOOR		
	WIDTH	DEPTH	WIDTH	DEPTH	WIDTH	DEPTH	WIDTH	TYPE	MAX TRAVEL
CAPACITY	A	B	C	D	E	F	G		
2000	7'-8"	6'-10"	6'-0"	5'-0"	5'-8"	4'-3"	3'-0"	SSSO	220'
2500	8'-8"	6'-10"	7'-0"	5'-0"	6'-8"	4'-3"	3'-6"	SSSO	220'
3000	8'-8"	7'-4"	7'-0"	5'-6"	6'-8"	4'-9"	3'-6"	SSSO	220'
3500	8'-8"	8'-0"	7'-0"	6'-2"	6'-8"	5'-5"	3'-6"	SSSO	220'
4000	9'-8"	8'-0"	8'-0"	6'-2"	7'-8"	5'-5"	4'-0"	2SSO	220'

Note: Center opening doors available for all sizes except 2000 lb. Car.
 For car sizes or configurations not shown, please call Port Elevator Inc.

Passenger - Overhead Traction

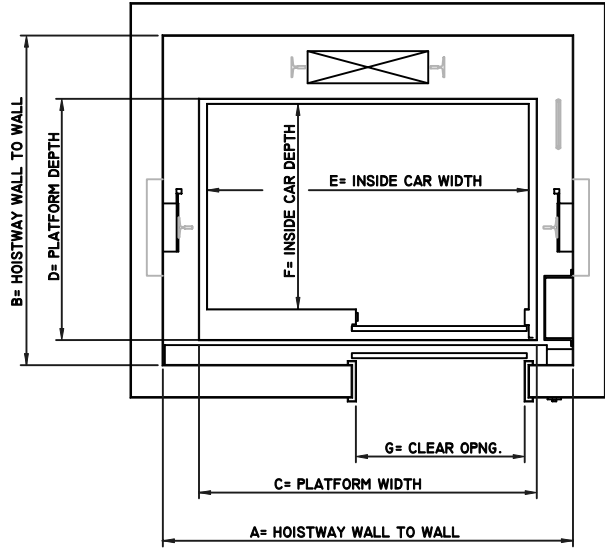
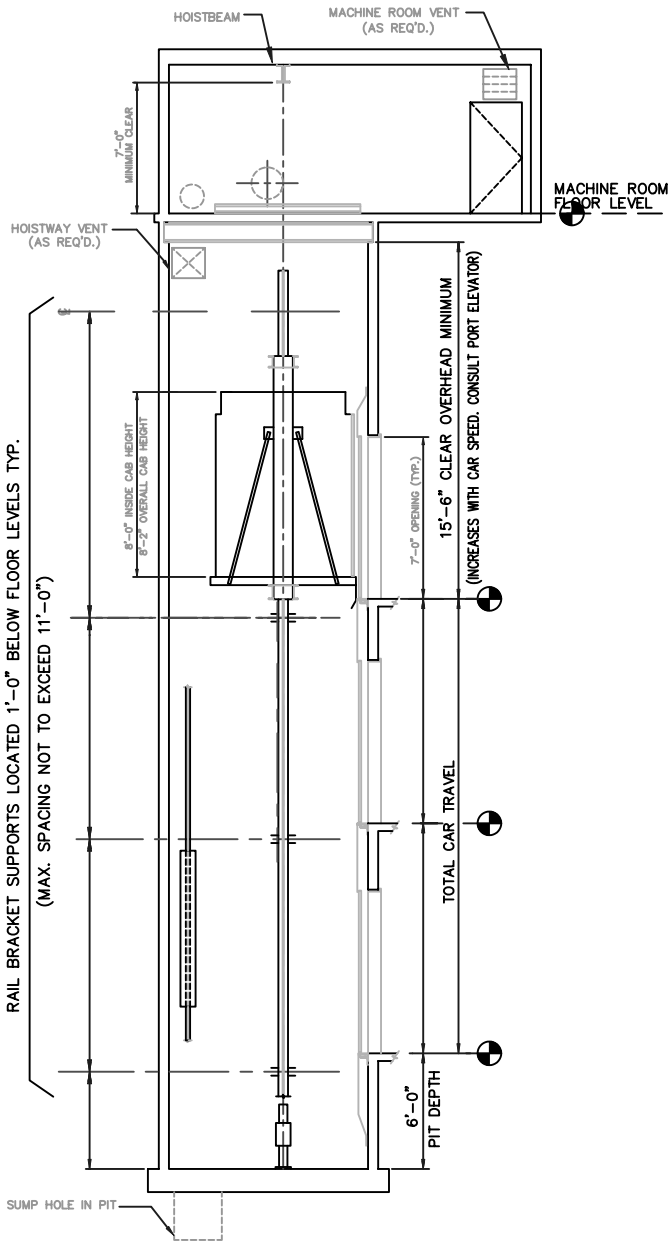

PASSENGER - OVERHEAD TRACTION - FRONT OPENINGS ONLY

	HOISTWAY		PLATFORM		CLEAR INSIDE CAR		DOOR		
	WIDTH	DEPTH	WIDTH	DEPTH	WIDTH	DEPTH	WIDTH		
CAPACITY	A	B	C	D	E	F	G	TYPE	MAX TRAVEL
2000	7'-6"	6'-10"	6'-0"	5'-0"	5'-8"	4'-3"	3'-0"	SSSO	220'
2500	8'-6"	6'-10"	7'-0"	5'-0"	6'-8"	4'-3"	3'-6"	SSSO	220'
3000	8'-6"	7'-4"	7'-0"	5'-6"	6'-8"	4'-9"	3'-6"	SSSO	220'
3500	8'-6"	8'-0"	7'-0"	6'-2"	6'-8"	5'-5"	3'-6"	SSSO	220'
4000	9'-6"	8'-0"	8'-0"	6'-2"	7'-8"	5'-5"	4'-0"	2SSO	220'

Note: Center opening doors available for all sizes except 2000 lb. Car.
 For car sizes or configurations not shown, please call Port Elevator Inc.